

A. Drip Edge – Diverts water away from house along entire eave.

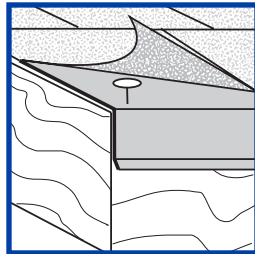

B. Eave Edge – Diverts water away from house along entire eave.

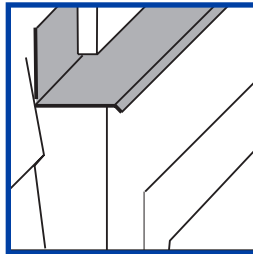

C. Drip Cap – Diverts water away from windows and doors.

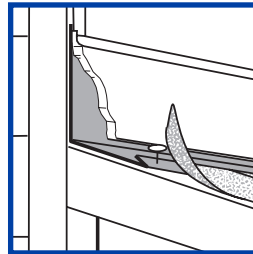

D. Shingle Endwall Flashing – Prevents water infiltration at a wall. Diverts water away from house.

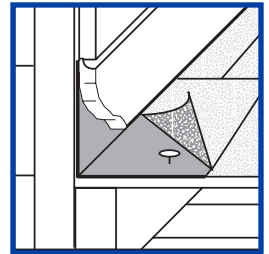

E. Angle Flashing – Prevents water infiltration at a wall. Diverts water away from house.

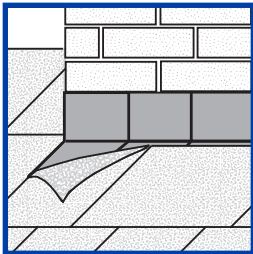

F. Step Flashing – Prevents leaks around chimneys or other small areas.

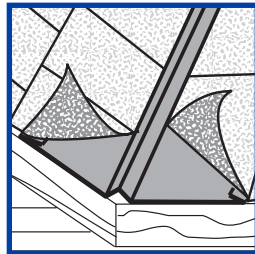

G. Preformed Valley – Prevents water penetration at valley.

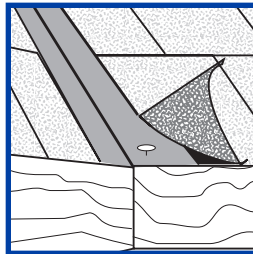

H. Rolled Flashing – Prevents water penetration where two roof faces meet.

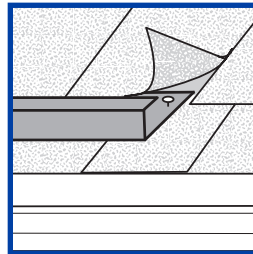

I. Rain Diverter – Diverts water away from doorway. Apply over entrances only.

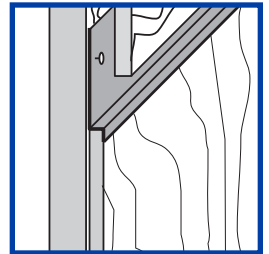

J. Z-Flashing – Prevents leakage where two pieces of siding meet.

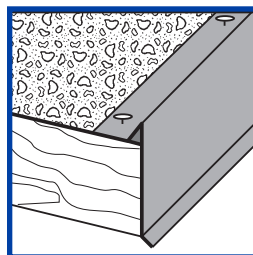
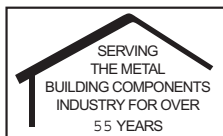

K. Gravel Stop – Prevents gravel from washing off a gravel roof. Apply across entire eave.

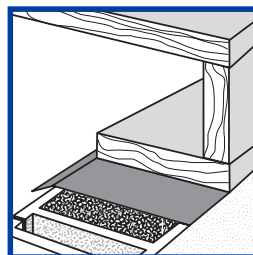

L. Termite Shield – Prevents termites from getting access to sills and wooden structure.



ROOF EDGES

Galvanized

Aluminum

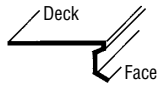

A. Drip Edge

Size	Deck	Face	29ga	26ga	Std Wh/Br	26ga Wh/Br	Mill	Wh/Br	Black
4-1/2" x 10'	2-1/4"	1-1/2"	•		•		•	•	
5" x 10'	3"	1-1/2"	•		•			•	•
6" x 10'	3"	2-1/2"	•	•	•	•		•	

Aluminum packaged 50 per box, Galvanized packaged 25 per box

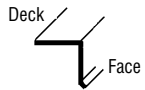

B. Eave Edge

Size	Deck	Face	29ga	26ga	Std Wh/Br	26ga Wh/Br	Mill	Wh/Br	Black
2" x 2" x 10'	2"	2"	•	•		•			
2-1/2" x 2-1/2" x 10'	2-1/2"	2-1/2"		•					
3" x 3" x 10'	3"	3"		•		•			

Packaged 25 per bundle

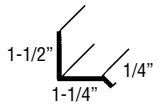

C. Drip Cap

Size	Deck	Face	29ga	26ga	Std Wh/Br	26ga Wh/Br	Mill	Wh/Br	Black
1-1/2" x 1-1/2" x 10'	1-1/2"	1-1/2"	•	•				•	

Packaged 50 per bundle

FLASHINGS

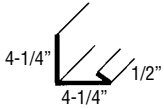

D. Shingle Endwall Flashing

4-1/4" x 4-1/4" x 1/2" x 10'			•		•				
------------------------------	--	--	---	--	---	--	--	--	--



E. Angle Flashing

4" x 4" x 10'			•						
4" x 5" x 10'			•						
5" x 5" x 10'			•	•					
5" x 7" x 10'			•	•					
6" x 6" x 10'			•						



F. Step Flashing

3" x 4" x 7"							•		
2-1/2" x 2-1/2" x 7"						•	•		
5" x 7" (flat)							•		

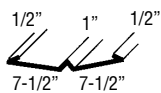

G. Preformed Valley

18" x 10'			•	•	•				
-----------	--	--	---	---	---	--	--	--	--



H. Rolled Flashing

Size	Std	29ga	26ga	Std Wh/Br	26ga Wh/Br	Mill	Wh/Br	Black
8" x 50'			•			•		
10" x 50'	•	•	•			•		
12" x 50'	•	•	•			•		
14" x 50'	•	•	•			•		
16" x 50'	•	•	•			•		
20" x 50'	•	•	•	•	•	•		
24" X 50'			•			•		
36" X 50'			•			•		
8" x 10'			•			•		
10" x 10'	•	•	•			•	•	
12" x 10'			•			•		
14" x 10'	•	•	•			•	•	
16" x 10'			•			•		
20" x 10'	•	•	•			•		

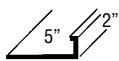

I. Rain Diverter

5" x 2" x 1/2" x 10'			•						•
----------------------	--	--	---	--	--	--	--	--	---



J. Z Flashing

2" x 5/8" x 3/8" x 10'			•						
2" x 3/8" x 5/8" x 10'			•						
1" x 5/8" x 3/8" x 10'						•	•		
1" x 3/8" x 5/8" x 10'						•	•		



K. 5" Gravel Stop

2" x 3/4" x 2" x 1/4" x 10'			•						
-----------------------------	--	--	---	--	--	--	--	--	--



L. Termite Shield

4" x 2" x 10'			•						
---------------	--	--	---	--	--	--	--	--	--